

TYPICAL SECTION ADJACENT TO CARRIAGEWAY
SECTION A

Notes:

- DO NOT SCALE FROM THIS DRAWING.
- ALL DIMENSIONS ARE IN METRES UNLESS STATED OTHERWISE.
- THIS DRAWING IS TO BE READ IN CONJUNCTION WITH ALL RELEVANT DRAWINGS AND DOCUMENTS ASSOCIATED WITH THIS PROJECT

P1				
REV.	DETAILS	DRAWN	CHECKED	DATE
CLIENT: MORAY COUNCIL				
PROJECT: Hopeman to Lossiemouth Cycle Design				
DRAWING TITLE: Route 3B Proposed Layout				
SCALES: 1:1000 @ A1				
DRAWN: CN	CHECKED: JD	DATE: 26.11.18		
WYG Transport Planning part of the WYG group				
The Cube 45 Leith Street Edinburgh EH1 3AT t: +44 (0)131 247 5700 e: edinburgh@wyg.com				
DRAWING NUMBER: A110395_207				REVISION: P1

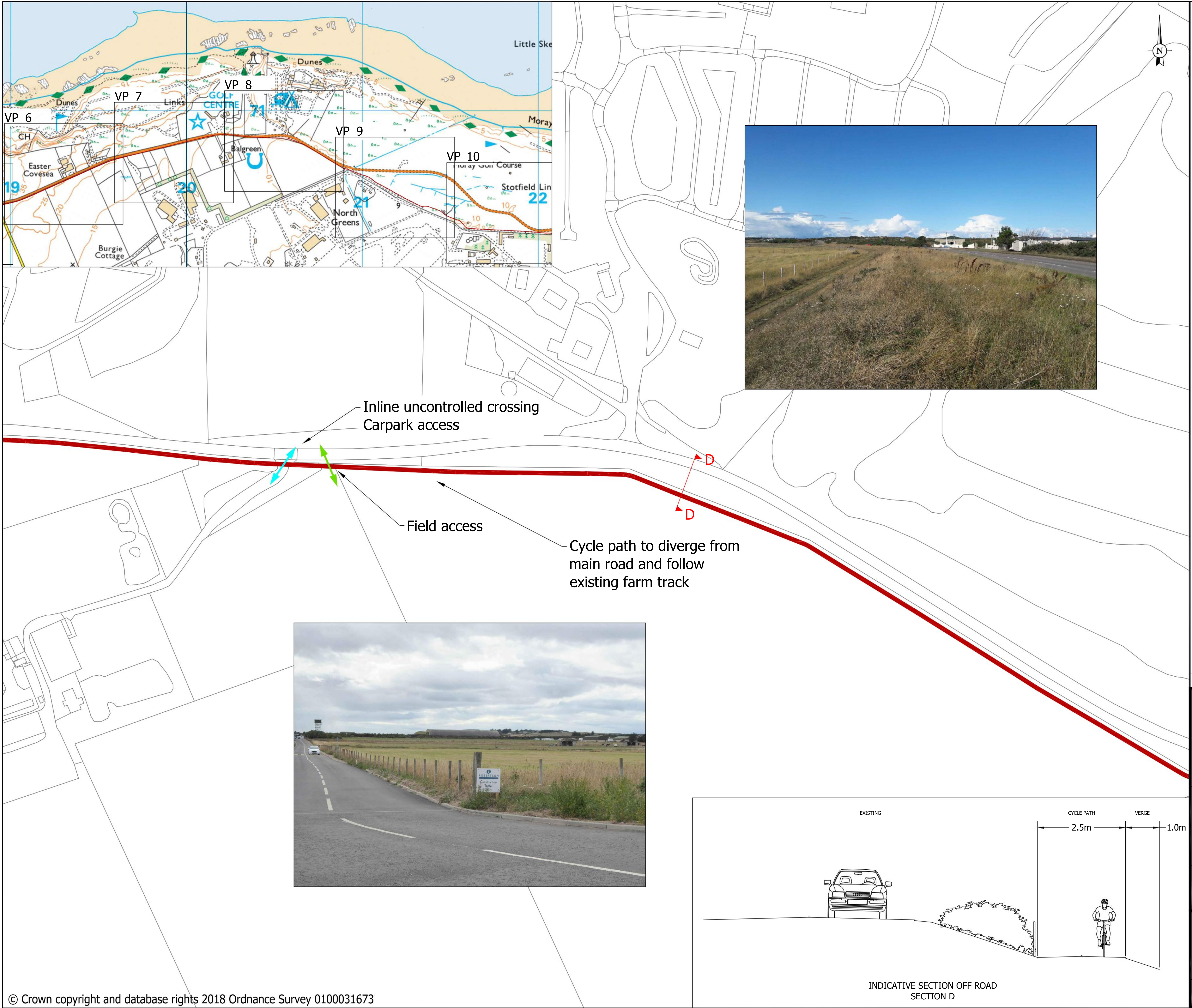

Notes:

- DO NOT SCALE FROM THIS DRAWING.
- ALL DIMENSIONS ARE IN METRES UNLESS STATED OTHERWISE.
- THIS DRAWING IS TO BE READ IN CONJUNCTION WITH ALL RELEVANT DRAWINGS AND DOCUMENTS ASSOCIATED WITH THIS PROJECT

REV.	DETAILS	DRAWN	CHECKED	DATE
P1				

CLIENT: MORAY COUNCIL

PROJECT: Hopeman to Lossiemouth Cycle Design

DRAWING TITLE: Route 3B Proposed Layout

SCALES: 1:1000 @ A1

DRAWN	CN	CHECKED	JD	DATE	26.11.18
WYG Transport Planning part of the WYG group					
The Cube 45 Leith Street Edinburgh EH1 3AT t: +44 (0)131 247 5700 e: edinburgh@wyg.com					

DRAWING NUMBER: A110395_208

REVISION: P1

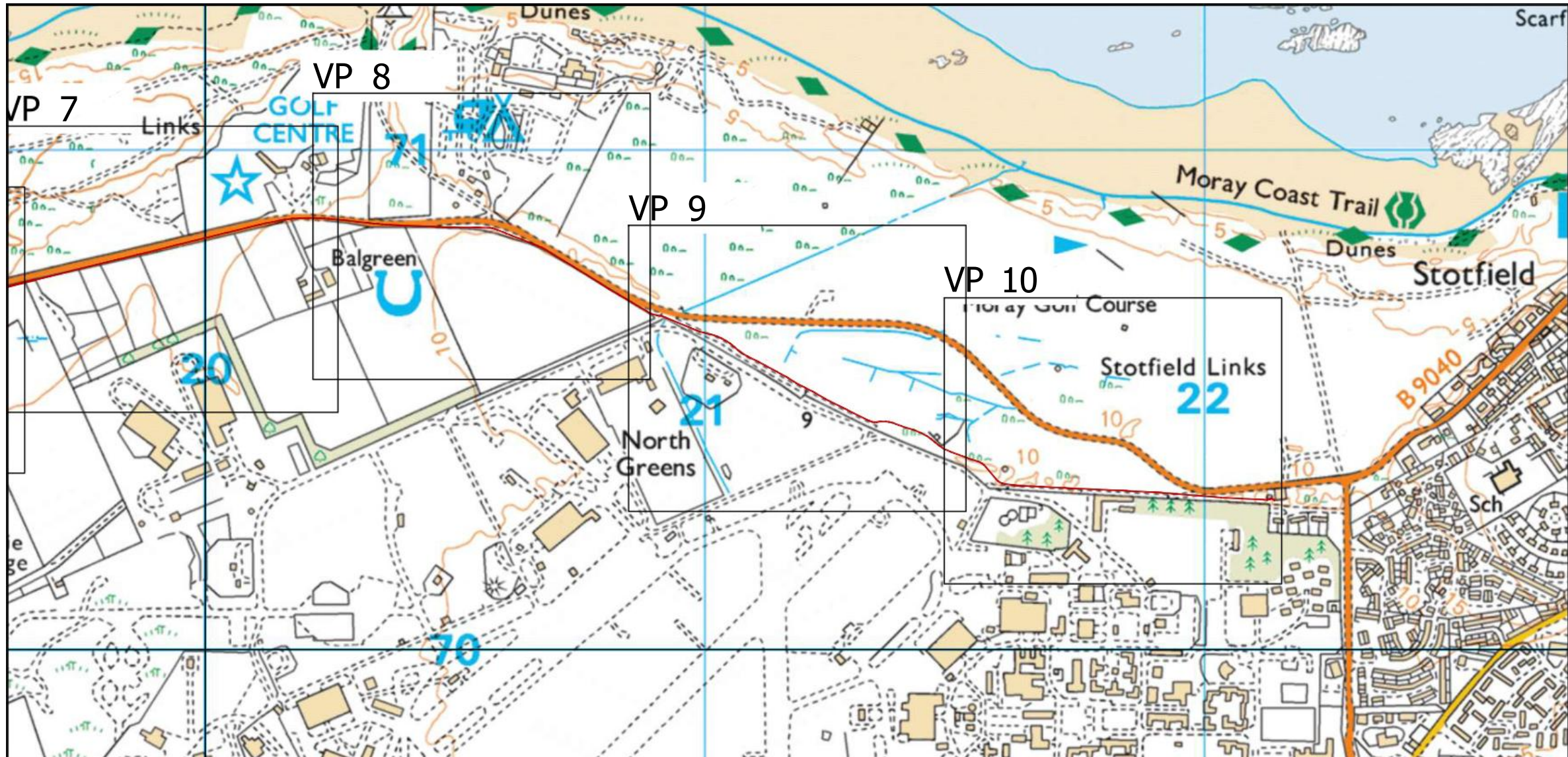

Cycle path to tie back into existing carriageway level.

Uncontrolled carriageway crossing as per Fig. 7.9 of Cycling by Design to be provided.

Cycle path to follow existing access track.

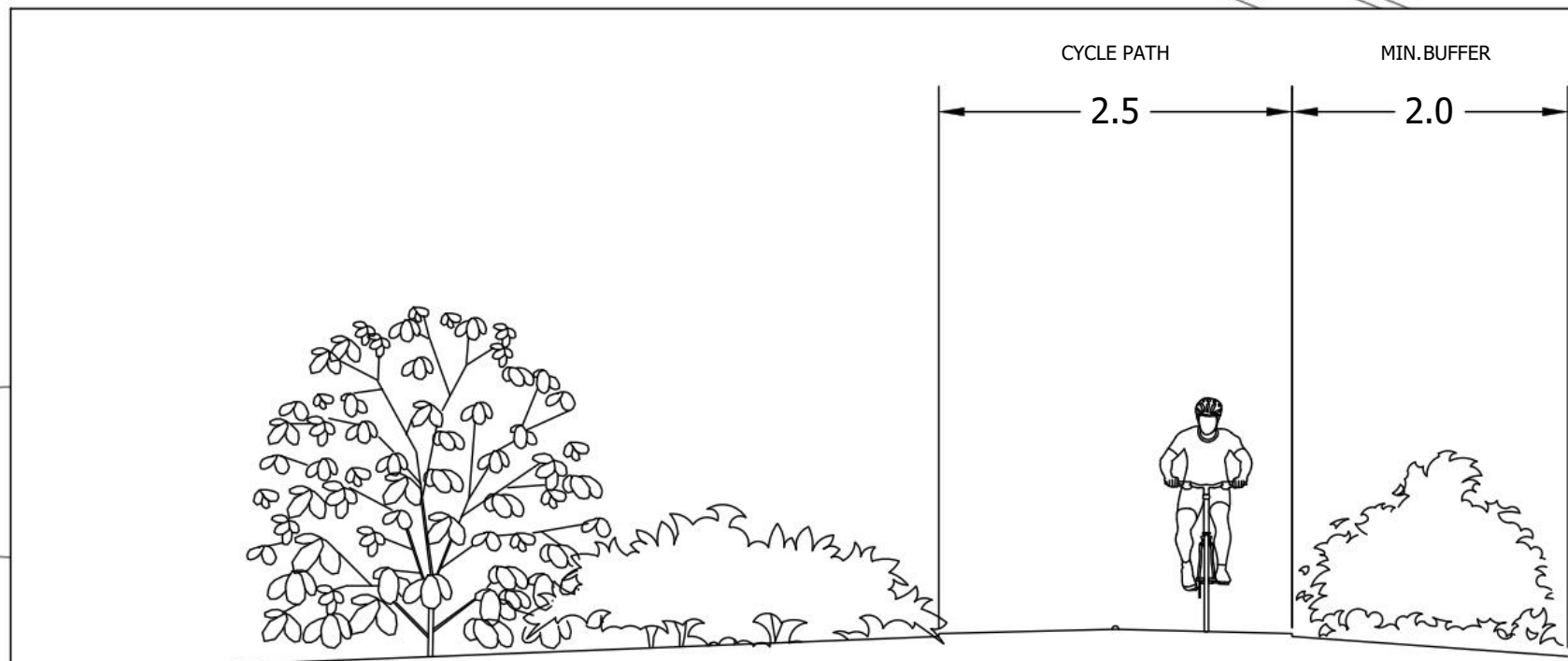

INDICATIVE SECTION OFF ROAD
SECTION E

- Notes:
1. DO NOT SCALE FROM THIS DRAWING.
 2. ALL DIMENSIONS ARE IN METRES UNLESS STATED OTHERWISE.
 3. THIS DRAWING IS TO BE READ IN CONJUNCTION WITH ALL RELEVANT DRAWINGS AND DOCUMENTS ASSOCIATED WITH THIS PROJECT

P1				
REV.	DETAILS	DRAWN	CHECKED	DATE

CLIENT:	MORAY COUNCIL			
PROJECT:	Hopeman to Lossiemouth Cycle Design			
DRAWING TITLE:	Route 3B Proposed Layout			
SCALES:	1:1000 @ A1			
DRAWN:	CN	CHECKED:	JD	DATE: 26.11.18
WYG Transport Planning part of the WYG group				
The Cube 45 Leith Street Edinburgh EH1 3AT t: +44 (0)131 247 5700 e: edinburgh@wyg.com				
DRAWING NUMBER:	A110395_209			REVISION: P1

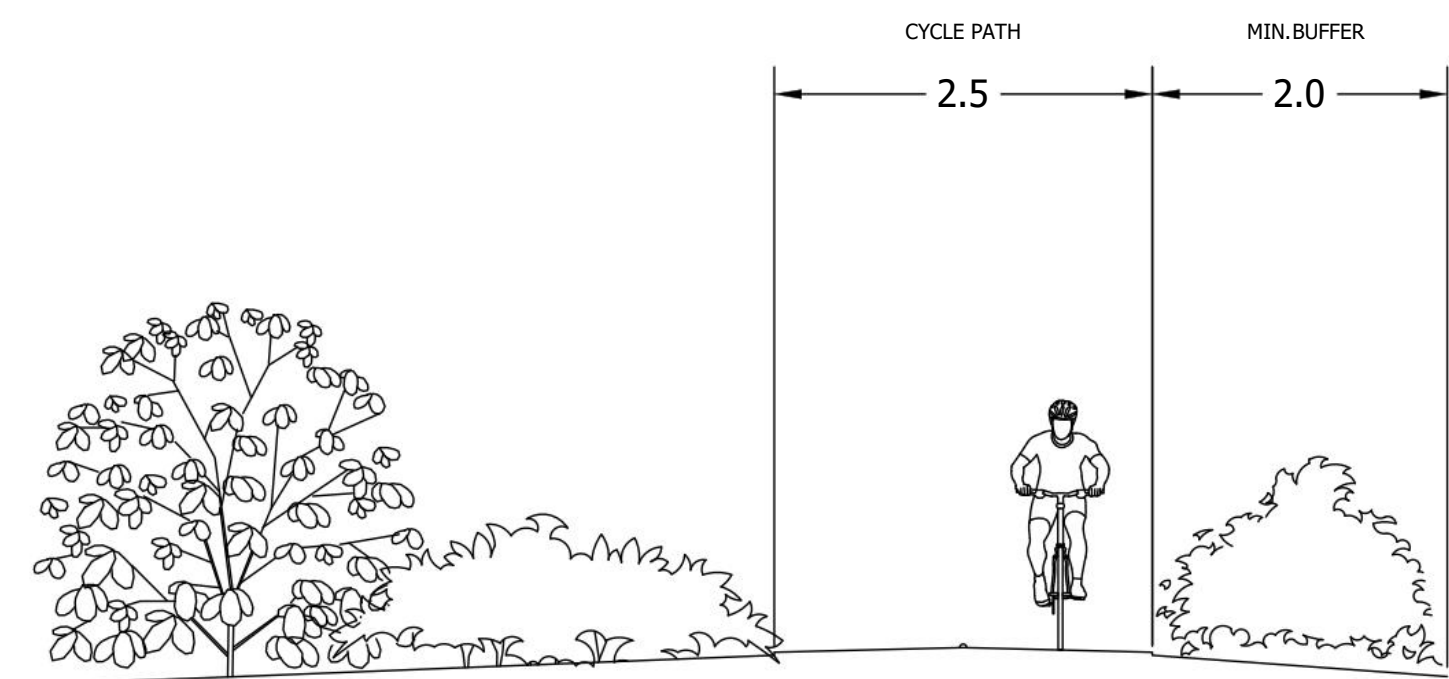
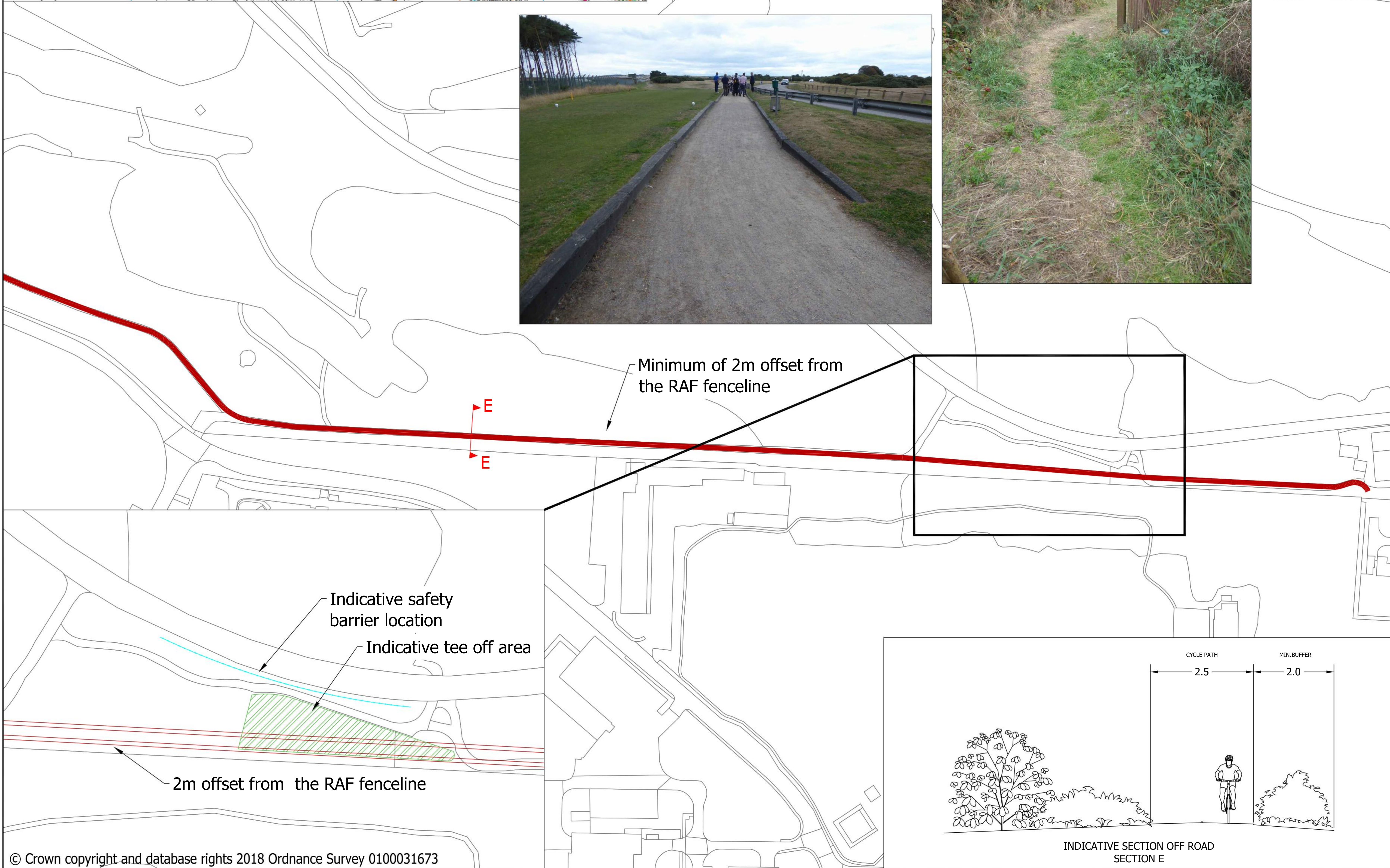
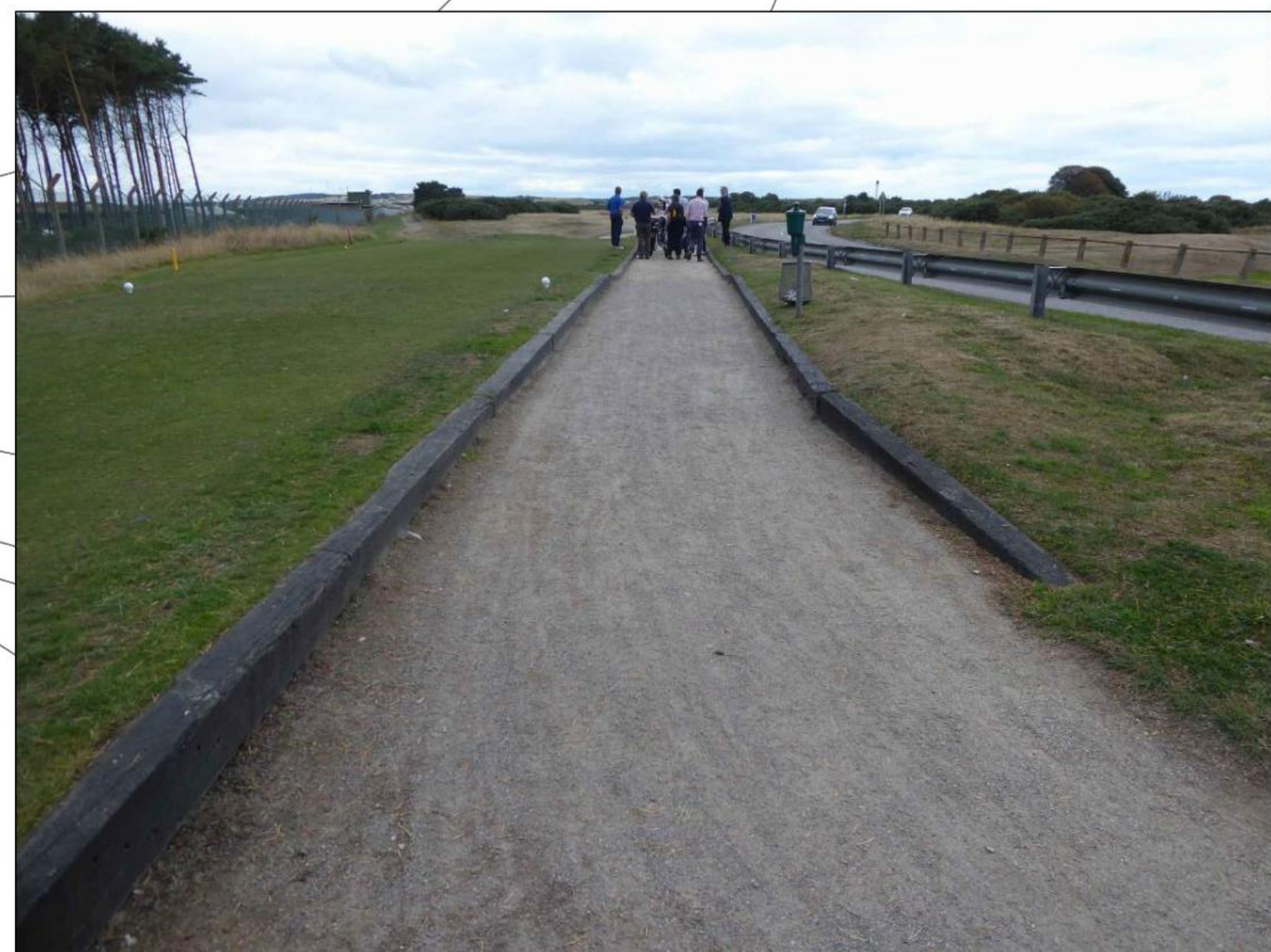
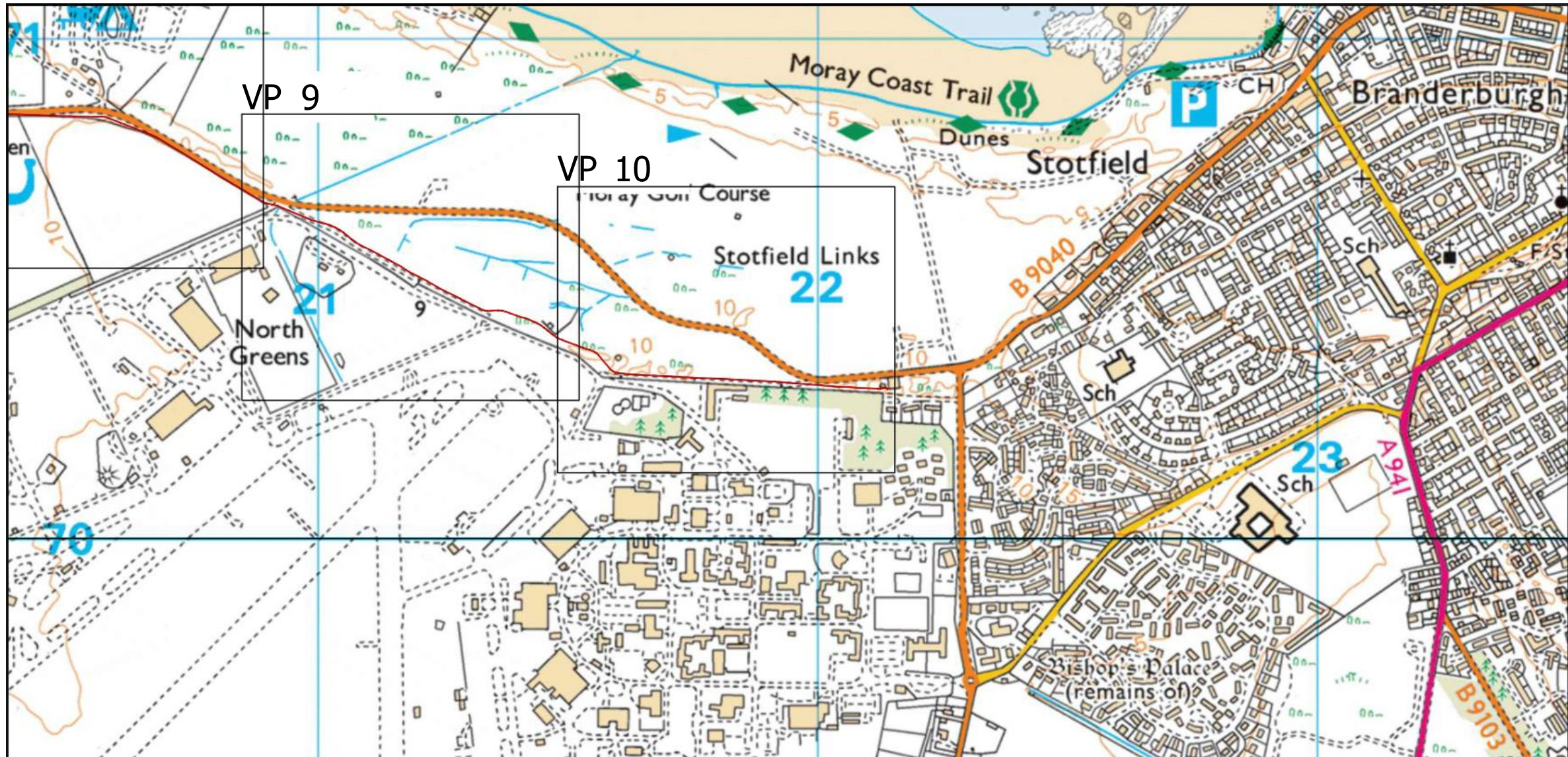

INDICATIVE SECTION OFF ROAD
SECTION E

Notes:

- DO NOT SCALE FROM THIS DRAWING.
- ALL DIMENSIONS ARE IN METRES UNLESS STATED OTHERWISE.
- THIS DRAWING IS TO BE READ IN CONJUNCTION WITH ALL RELEVANT DRAWINGS AND DOCUMENTS ASSOCIATED WITH THIS PROJECT

REV. P1 DETAILS DRAWN CHECKED DATE

CLIENT: MORAY COUNCIL

PROJECT: Hopeman to Lossiemouth Cycle Design

DRAWING TITLE: Route 3B Proposed Layout

SCALES: 1:1000 @ A1

DRAWN: CN CHECKED: JD DATE: 26.11.18

WYG Transport Planning
part of the WYG group

The Cube 45 Leith Street Edinburgh EH1 3AT
t: +44 (0)131 247 5700 e: edinburgh@wyg.com

DRAWING NUMBER: A110395_210 REVISION: P1

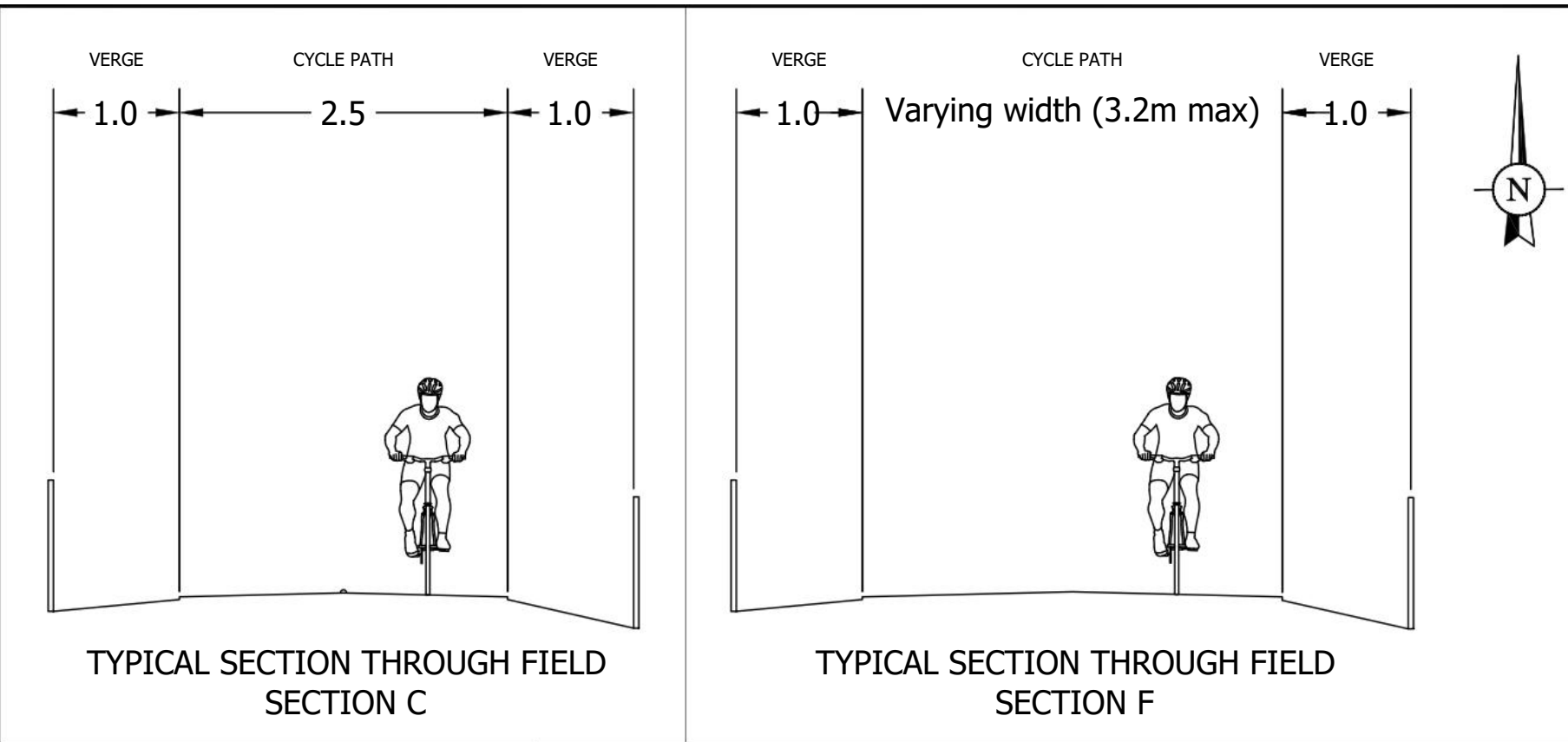
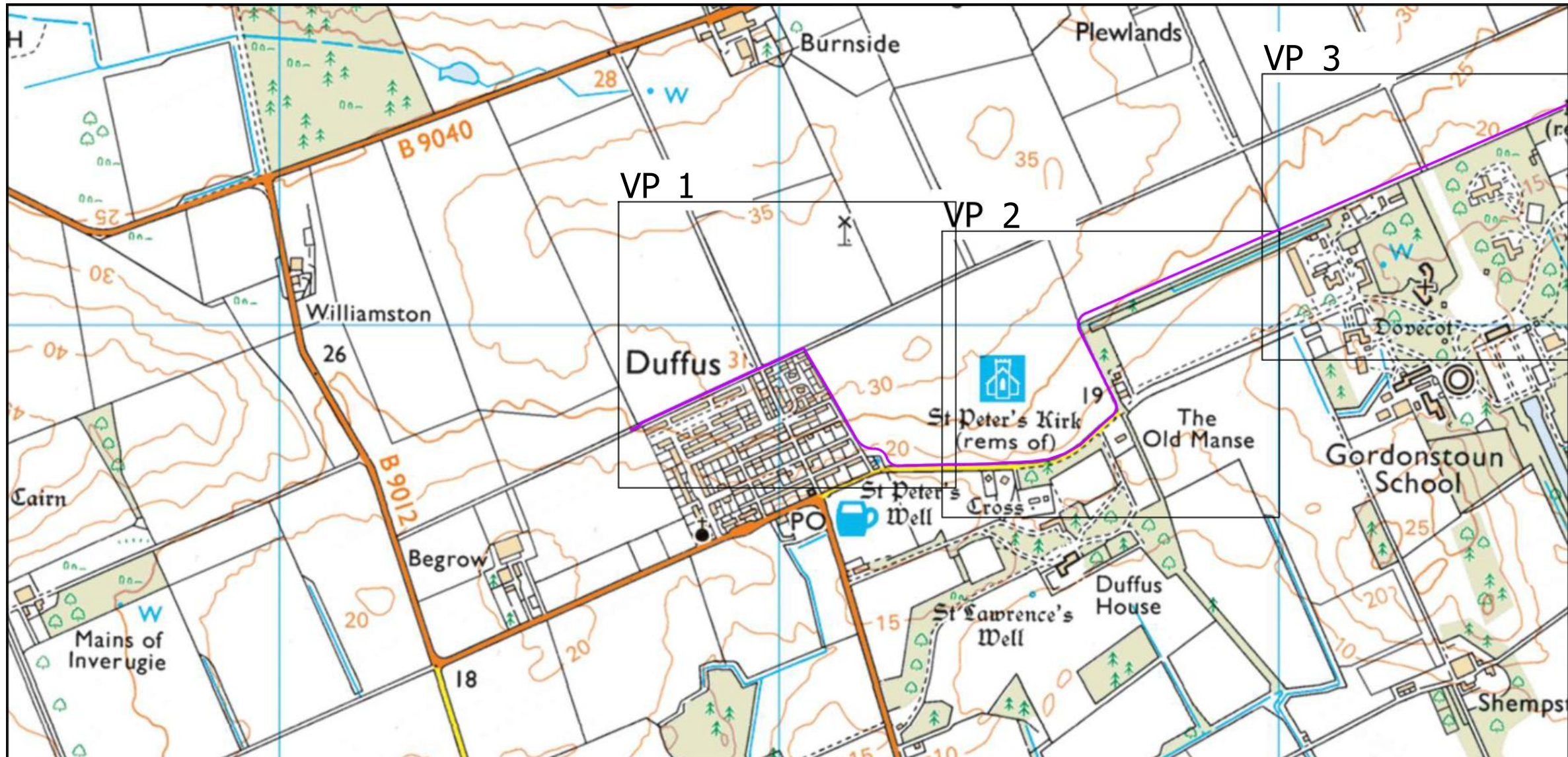

- Notes:
1. DO NOT SCALE FROM THIS DRAWING.
 2. ALL DIMENSIONS ARE IN METRES UNLESS STATED OTHERWISE.
 3. THIS DRAWING IS TO BE READ IN CONJUNCTION WITH ALL RELEVANT DRAWINGS AND DOCUMENTS ASSOCIATED WITH THIS PROJECT



P1				
REV.	DETAILS	DRAWN	CHECKED	DATE
CLIENT:				
MORAY COUNCIL				
PROJECT:				
Hopeman to Lossiemouth Cycle Design				
DRAWING TITLE:				
Route 4a Proposed Layout				
SCALES:				
1:1000 @ A1				
DRAWN:	CN	CHECKED:	JD	DATE: 26.11.18
WYG Transport Planning				
part of the WYG group				
The Cube 45 Leith Street Edinburgh EH1 3AT t: +44 (0)131 247 5700 e: edinburgh@wyg.com				
DRAWING NUMBER:				
A110395_401				
REVISION:				
P1				

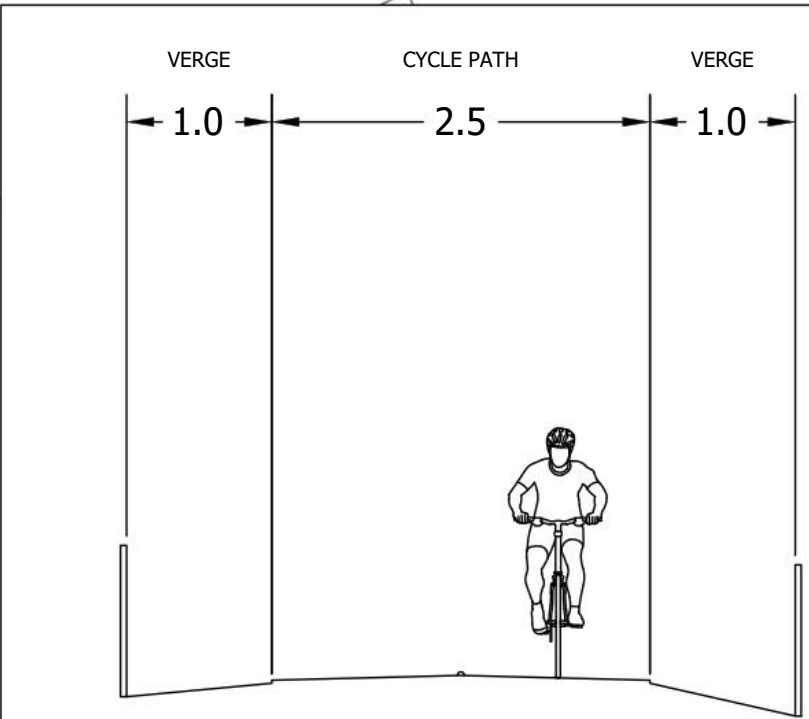
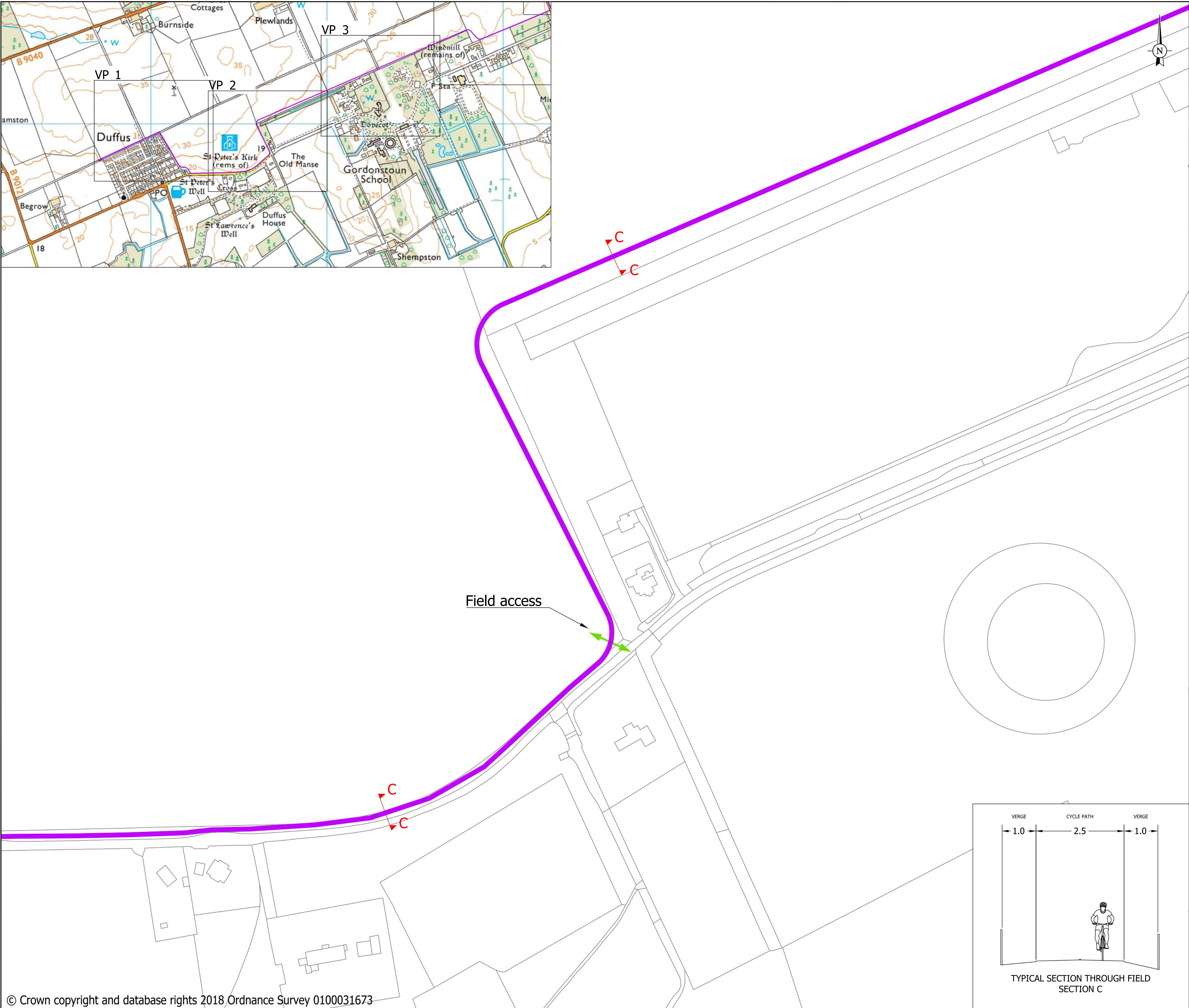
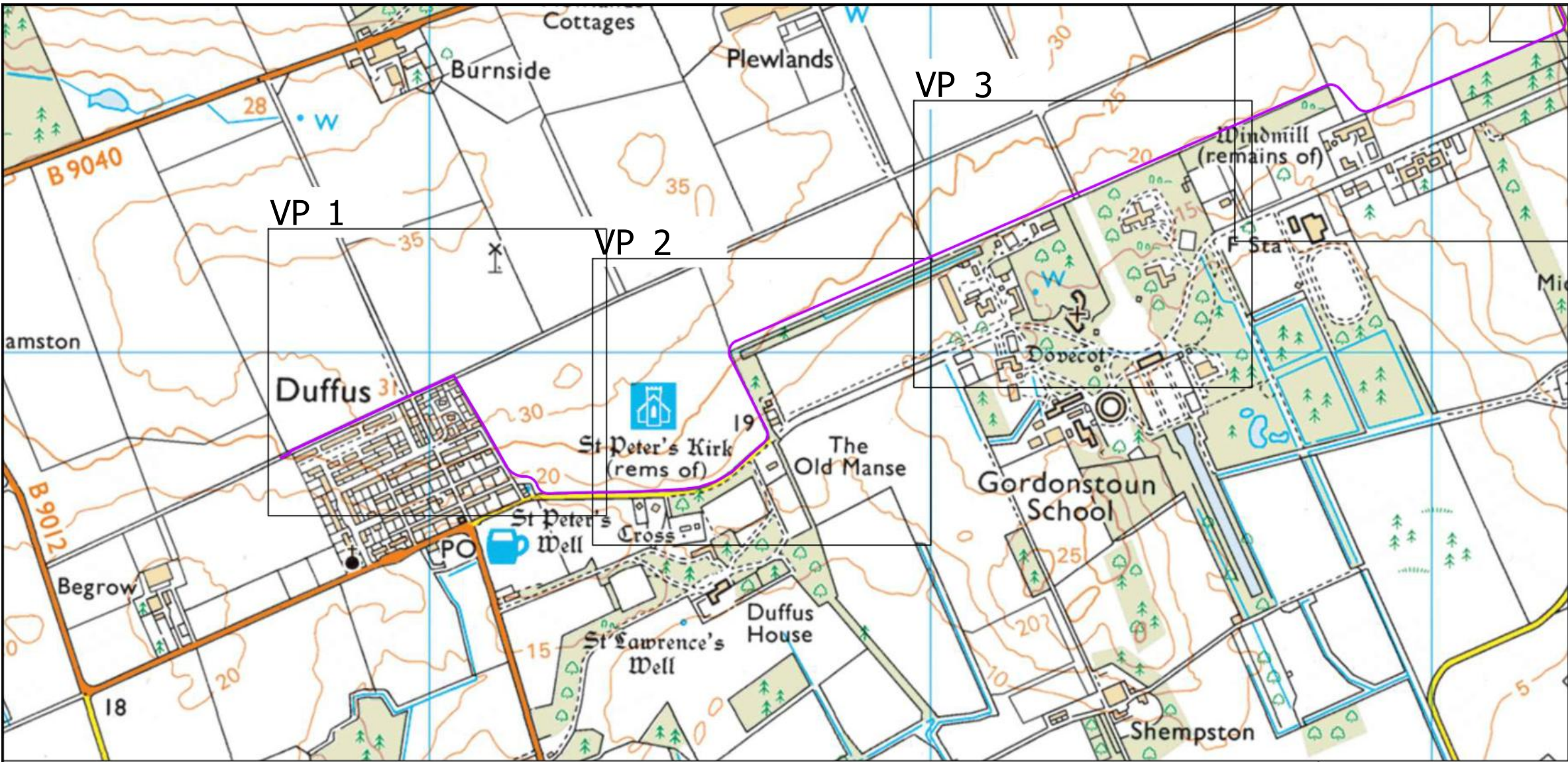

TYPICAL SECTION THROUGH FIELD
SECTION C

- Notes:
1. DO NOT SCALE FROM THIS DRAWING.
 2. ALL DIMENSIONS ARE IN METRES UNLESS STATED OTHERWISE.
 3. THIS DRAWING IS TO BE READ IN CONJUNCTION WITH ALL RELEVANT DRAWINGS AND DOCUMENTS ASSOCIATED WITH THIS PROJECT

P1				
REV.	DETAILS	DRAWN	CHECKED	DATE

CLIENT:
MORAY COUNCIL

PROJECT:
**Hopeman to Lossiemouth
Cycle Design**

DRAWING TITLE:
**Route 4a
Proposed Layout**

SCALES:
1:1000 @ A1

DRAWN: CN	CHECKED: JD	DATE: 26.11.18
--------------	----------------	-------------------

WYG Transport Planning
part of the WYG group

The Cube 45 Leith Street Edinburgh EH1 3AT
t: +44 (0)131 247 5700 e: edinburgh@wyg.com

DRAWING NUMBER:
A110395_402

REVISION:
P1

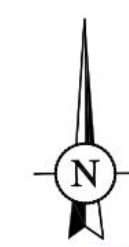
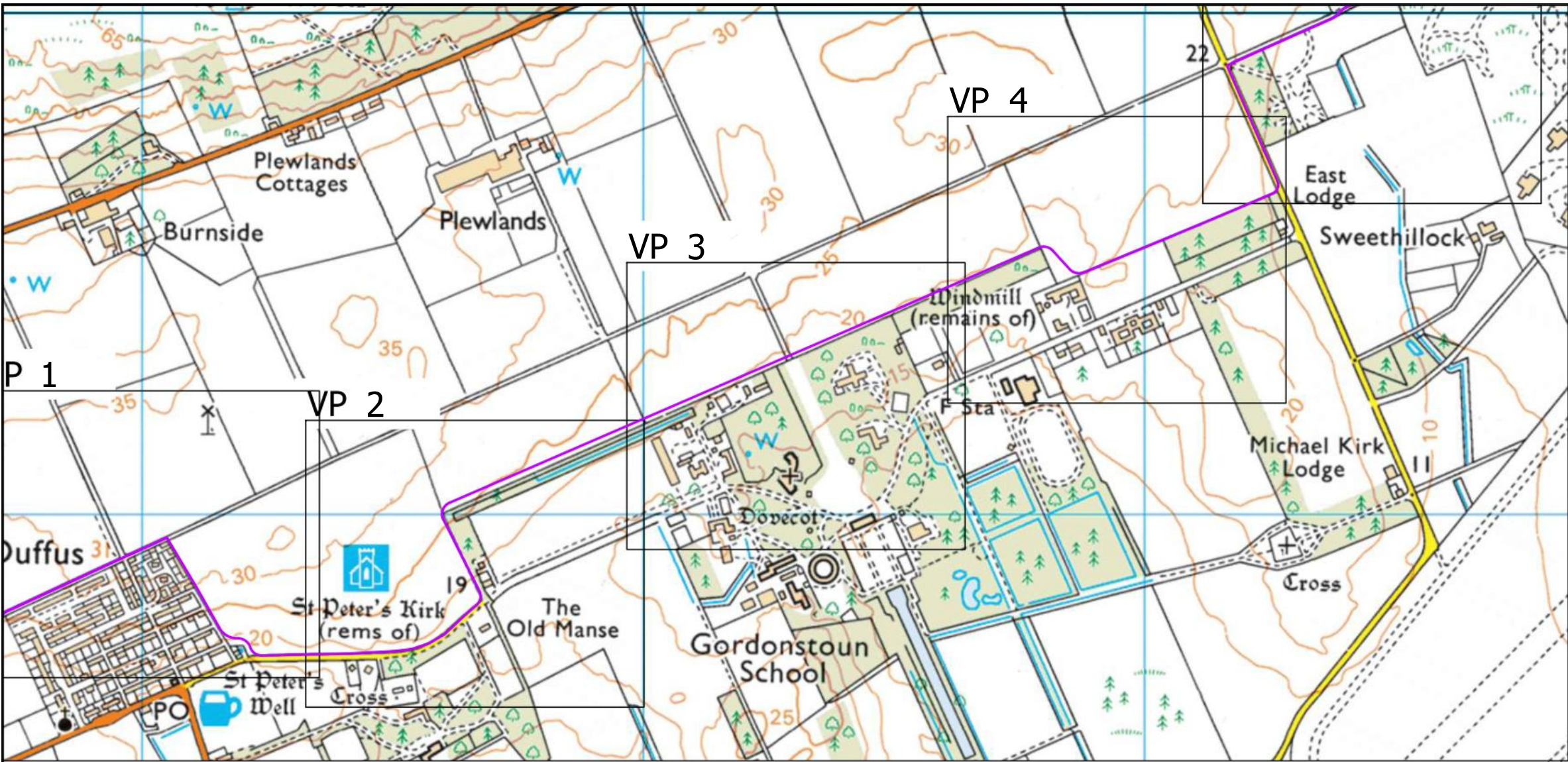

- Notes:
1. DO NOT SCALE FROM THIS DRAWING.
 2. ALL DIMENSIONS ARE IN METRES UNLESS STATED OTHERWISE.
 3. THIS DRAWING IS TO BE READ IN CONJUNCTION WITH ALL RELEVANT DRAWINGS AND DOCUMENTS ASSOCIATED WITH THIS PROJECT

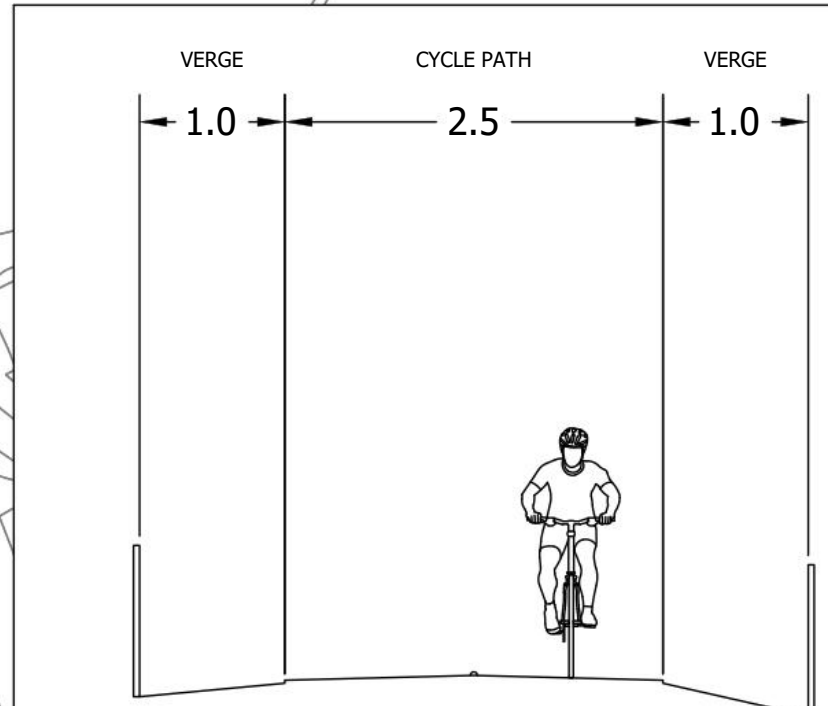

TYPICAL SECTION THROUGH FIELD
SECTION C

P1				
REV.	DETAILS	DRAWN	CHECKED	DATE
CLIENT: MORAY COUNCIL				
PROJECT: Hopeman to Lossiemouth Cycle Design				
DRAWING TITLE: Route 4a Proposed Layout				
SCALES: 1:1000 @ A1				
DRAWN: CN	CHECKED: JD	DATE: 26.11.18		
WYG Transport Planning part of the WYG group				
The Cube 45 Leith Street Edinburgh EH1 3AT t: +44 (0)131 247 5700 e: edinburgh@wyg.com				
DRAWING NUMBER: A110395_403				REVISION: P1

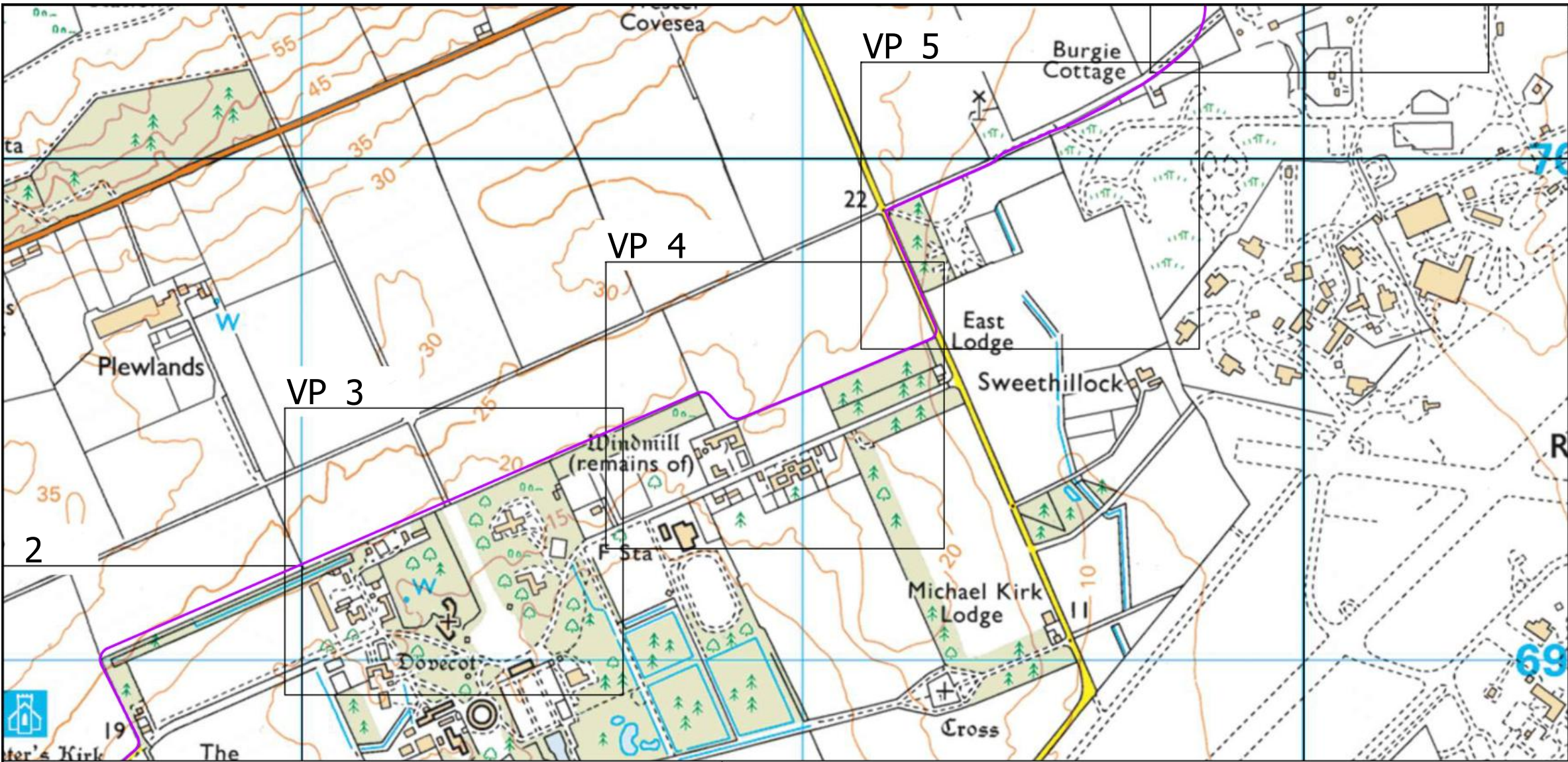

Route to follow carriageway separated by existing hedge

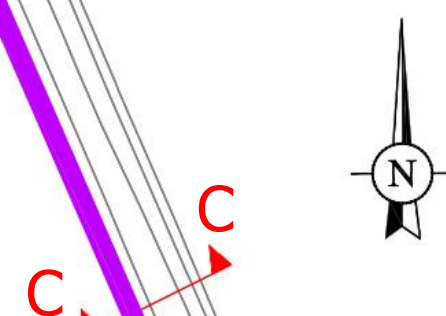

- Notes:
1. DO NOT SCALE FROM THIS DRAWING.
 2. ALL DIMENSIONS ARE IN METRES UNLESS STATED OTHERWISE.
 3. THIS DRAWING IS TO BE READ IN CONJUNCTION WITH ALL RELEVANT DRAWINGS AND DOCUMENTS ASSOCIATED WITH THIS PROJECT

P1				
REV.	DETAILS	DRAWN	CHECKED	DATE

CLIENT:
MORAY COUNCIL

PROJECT:
**Hopeman to Lossiemouth
Cycle Design**

DRAWING TITLE:
**Route 4a
Proposed Layout**

SCALES:
1:1000 @ A1

DRAWN: CN	CHECKED: JD	DATE: 26.11.18
-----------	-------------	----------------

WYG Transport Planning
part of the WYG group

The Cube 45 Leith Street Edinburgh EH1 3AT
t: +44 (0)131 247 5700 e: edinburgh@wyg.com



DRAWING NUMBER: A110395_404	REVISION: P1
---------------------------------------	------------------------

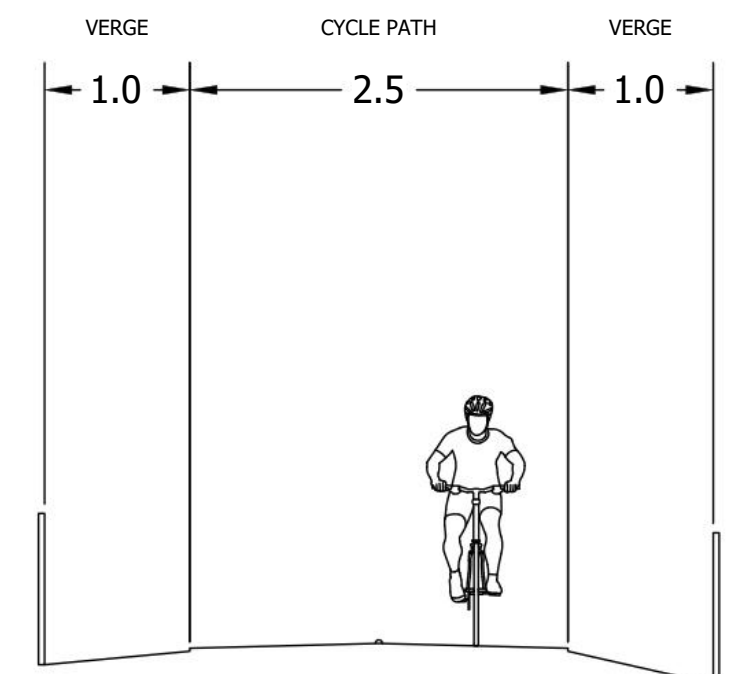

TYPICAL SECTION THROUGH FIELD
SECTION C